

Bishop's Palace Garden

Points of Interest



Entrance

Accessed through the Bishop's Palace Cannon Gate from Canon Lane off South Street



Point 1

Formal garden with its part Tudor wall and crenellations



Point 2

View westward from the middle gate with a choice of level and wide gravel paths with box hedging leading through the garden



Point 3

The Vista with its herbaceous beds planted in 2009. Parallel beds with warm colours towards the East becoming cooler to the West



Point 4

Rose pergola planted in 2009 carries climbing roses, clematis and honeysuckle



Point 5

Arboretum: About a hundred rare and unusual trees and shrubs extend over much of the garden



Point 6

Broadwalk bed: planted mainly with Mediterranean plants

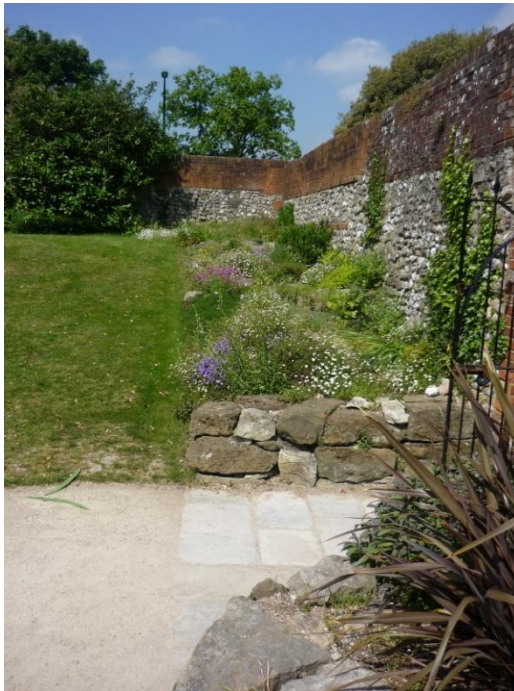

Point 7

Alpine garden by western entrance from Avenue de Chartres: from here there is an upper walk along the ramparts of the City Walls



Point 8

Upper walk along the ramparts looking across the garden towards Chichester Cathedral



Point 8a

Lower walk view towards the shallow pond and seats



Point 9

Eastern end of the southern ramparts accessed by a stepped path with handrails. Looking down through native low shrubs and trees towards the pond



Point 10

Wildlife garden with various habitats attracting and supporting insects and birds

The Friends of Bishop's Palace Garden hope that you enjoy your visit and that you will make return visits at different times of the year. To become a Friend please contact Chichester District Council on 01243 534695 or 01243 782747.

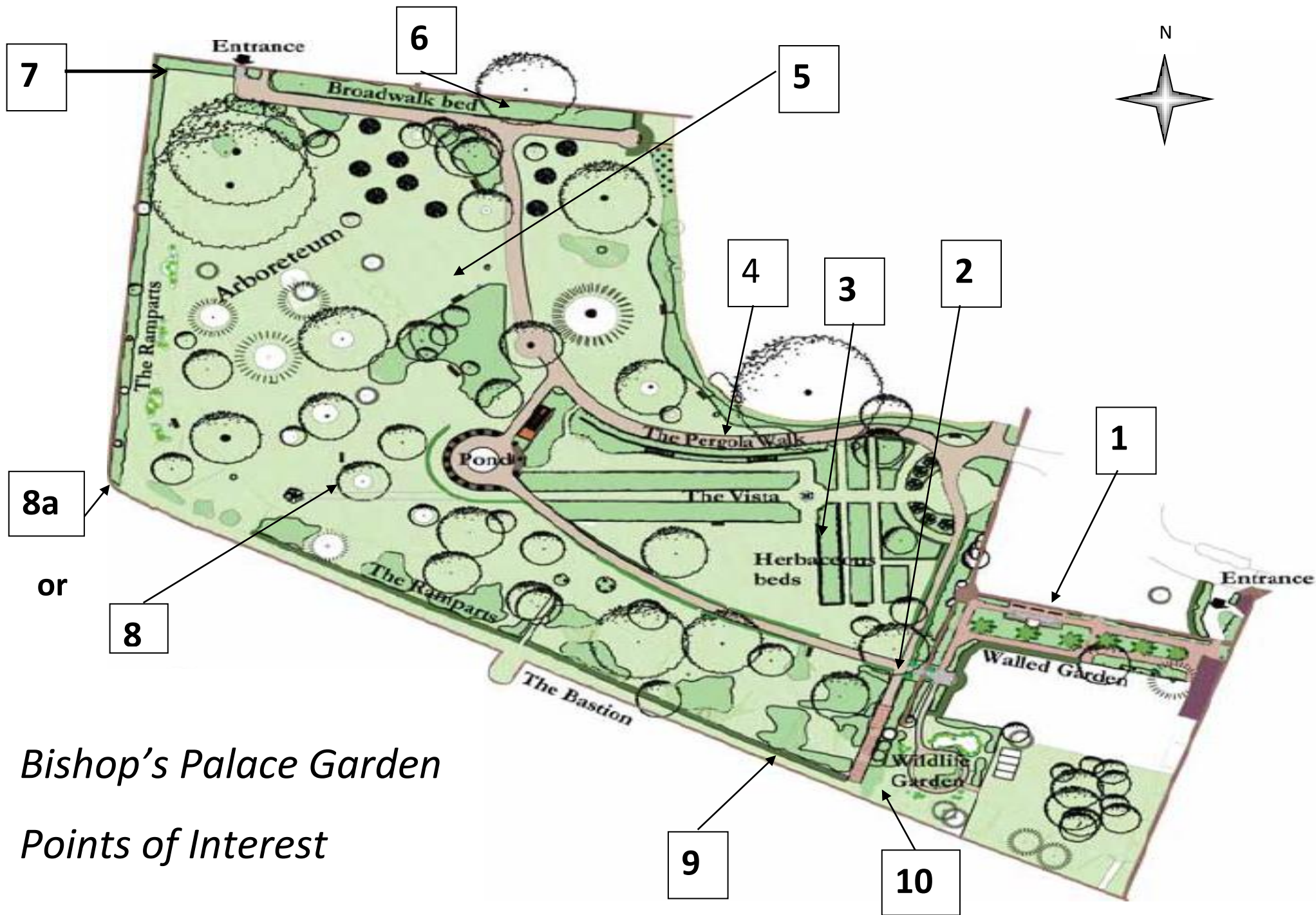

*Bishop's Palace Garden
Points of Interest*